

3RD ANNUAL CONFERENCE
OF THE

MiCropBiomes COST Action

Belgrade 3 – 5 June 2026

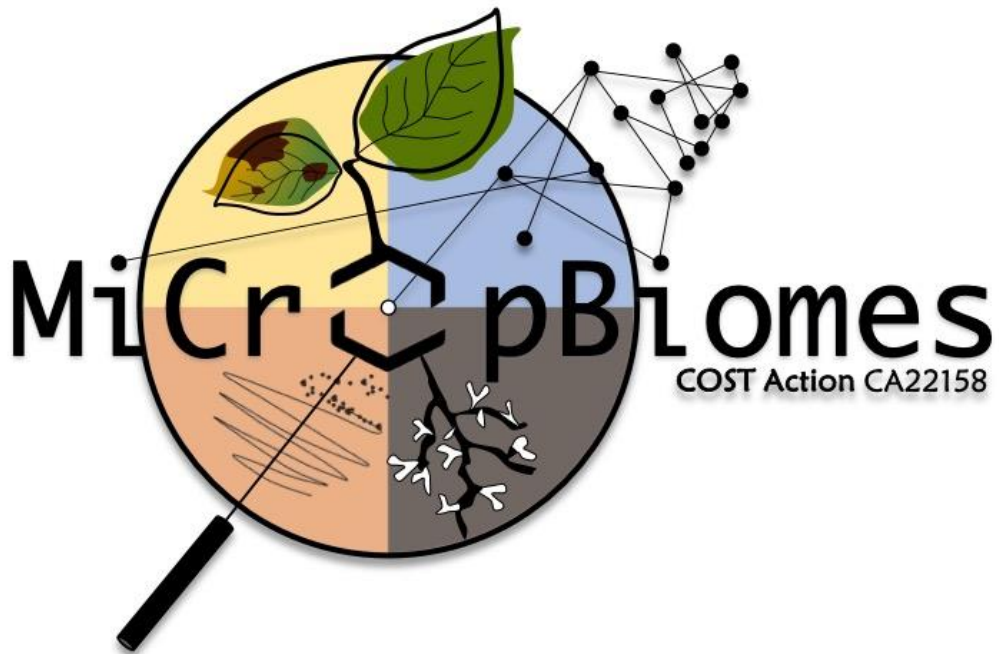

WELCOME !

The **third Annual Conference** of the MiCropBiomes COST Action CA22158 “Exploiting PlantMicrobiomes Networks and Synthetic Communities to improve Crops Fitness” will be held in Belgrade, Serbia, on **3 - 5 June 2026**, including working group meetings. We expect 60 - 70 participants.

The conference is organized by the **Faculty of Biology, University of Belgrade (FBUB)**, one of the leading institutions for biological sciences in Serbia. As part of the University of Belgrade, the largest and most influential academic institution in the region, the Faculty contributes to a vibrant scientific environment that brings together social sciences and humanities, medical sciences, natural sciences and mathematics, as well as technology and engineering.



Main building of the University of Belgrade at Studentski Trg (Students' Square) Originally built in the 19th century as the endowment of Miša Anastasijević.

The origins of higher biological education in Serbia dates back to the 19th century, when biology was taught within the Department of Natural Sciences and Mathematics at the University. Over time, this academic tradition developed into today's Faculty of Biology, which became an independent faculty within the University of Belgrade in 1995. Three years ago, the Faculty celebrated its first 170 years of biological education and research in Belgrade! Today, it represents the oldest and largest higher education and research institution in Serbia dedicated to biology, molecular biology, physiology, ecology, and environmental protection.

The Faculty consists of three institutes: the **Institute of Physiology and Biochemistry**, the **Institute of Zoology**, and the **Institute of Botany** together with the historically important **Jevremovac Botanical Garden**. Within these institutes operate numerous departments, research centers, and scientific collections, including a vivarium and herbarium, supporting both teaching and advanced research. The Faculty currently hosts more than two thousand students and over a hundred teachers and scientists, and maintains strong collaborations with national and international research partners.



Faculty of Philology building hosts two main institutes of the FBUB - the Institute of Physiology and Biochemistry and the Institute of Zoology. The photograph was taken during the celebration of 170 years of biological education in Belgrade.



The Jevremovac Botanical Garden houses the Institute of Botany. The images show the Japanese Garden, one of the most picturesque areas of the garden, and the Greenhouse with more than 1000 tropical, subtropical, and Mediterranean plant species.

FBUB Locations & Venue

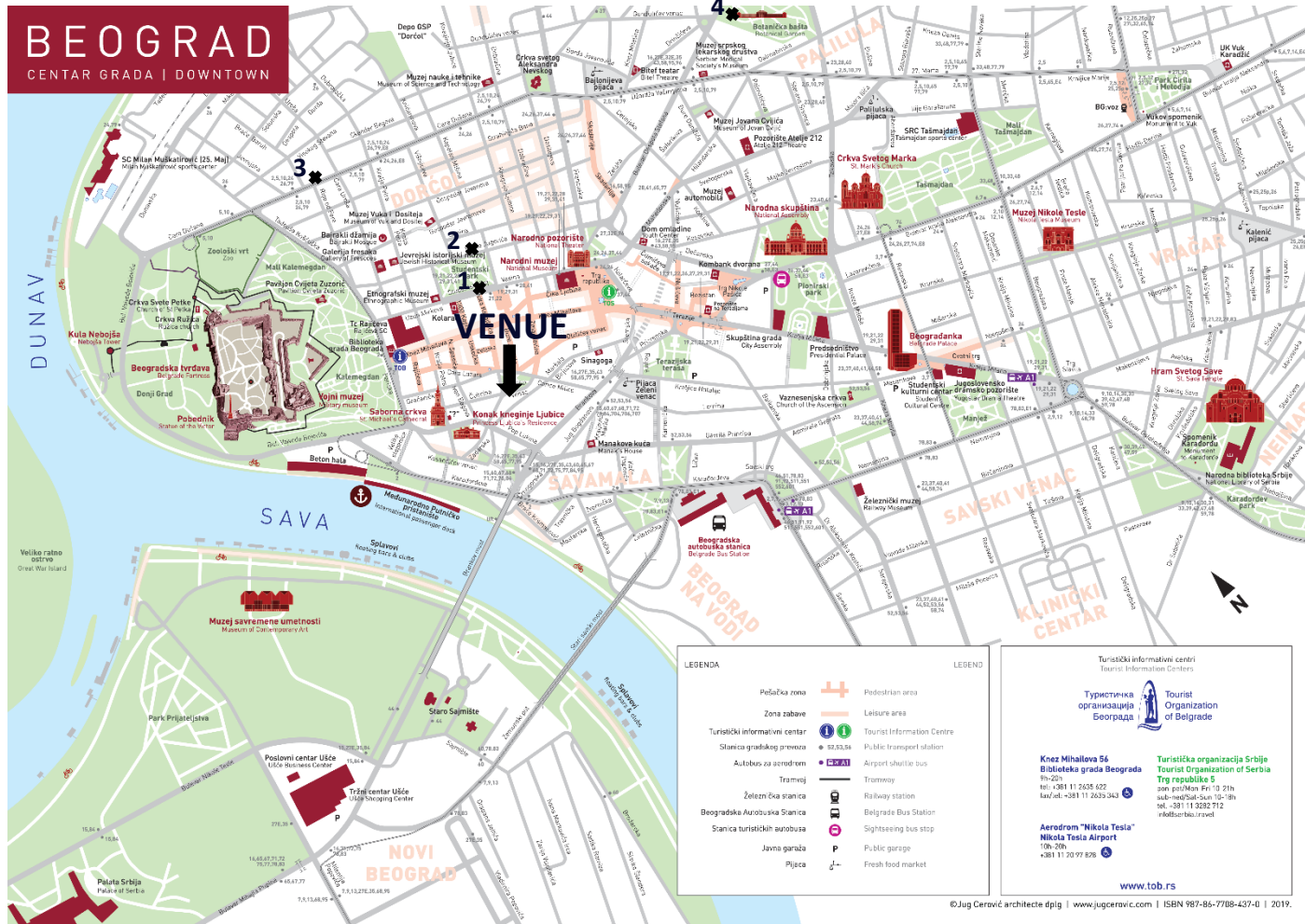

Black crosses indicate the FBUB's main locations: (1) Faculty of Philology, Studentski trg 3; (2) Faculty of Chemistry, Studentski trg 16; (3) Faculty of Physics, Cara Dušana 13; and (4) Jevremovac Botanical Garden, Takovska 43. The arrow marks the conference venue, Hotel "Palace" Topličin venac 23: <https://maps.app.goo.gl/tj1QF4H7r7LQYfydA>

All conference events and meetings will take place in the "Beogradska Panorama" ("Belgrade panorama") Hall, located on the top floor of the Hotel "Palace": <https://palacehotel.rs/>

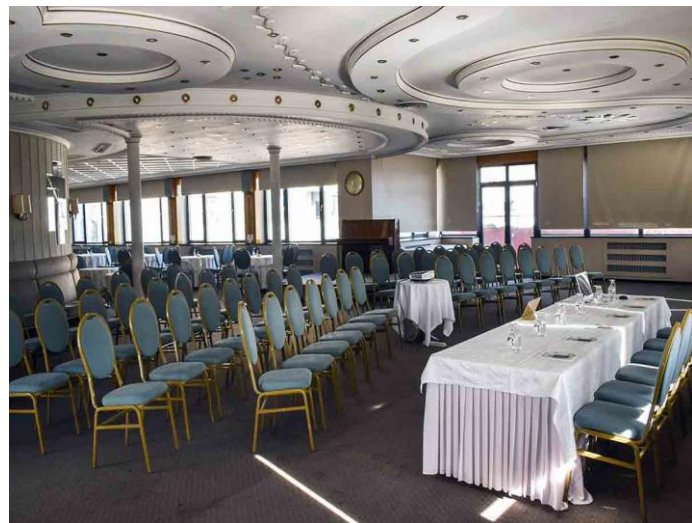

Street view of the "Palace" Hotel and the "Beogradska Panorama" Hall.

Conference organization

Topics and Working Groups

The conference will address the main topics of the MicropBiomes Cost Action and cover the focus of its five Topics of the Working Groups:

WG1 - Exploiting Plant-Microbiome molecular crosstalks: diversity, distribution and eco-evolutionary perspectives

WG2 - Crop-Microbiome assembly dynamics under specific environments

WG3 - Crop microbiomes and plant diseases: from dysbiosis to increased defenses

WG4 - From current microbial inoculants to synthetic communities

WG5 - Communication, and engagement with society

Organization and Scientific Committees

Scientific Committee

Scientific Committee	Role	WG	F/M	ICT	Country
Conceição SANTOS	Chair		F	Yes	PT
Francesco SPINELLI	Vice-Chair	3	M	No	IT
Ahmed ABDELFATTAH	Group Leader	1	M	Yes	DE
Ellodie VANDELLE	Group Leader	2	F	No	IT
Joël POTHIER	Group Leader	3	M	No	CH
Anna BONATERRA	Group Leader	4	F	No	SP
Caroline DE TENDER	Group Leader	5	F	No	BE
Gabriele BERG	Group vice-Leader	1	F	No	AU
Gordana RACIC	Group vice-Leader	2	F	Yes	RS
Renata ARTIMOVIĆ	Group vice-Leader	3	F	Yes	SK
Claire P-COMBARET	Group vice-Leader	4	F	No	FR
Ralf KOEBNIK	Group vice-Leader	5	M	No	FR
Ivan NIKOLIĆ	Grant Awarding coordinator	3	M	Yes	RS
Tanja BERIĆ	MC member	1	F	Yes	RS

Local Organization

Local Organization

Dr Ivan Nikolić
Prof. Dr Slaviša Stanković
Prof. Dr Tanja Berić
Prof. Dr Jelena Lozo
Dr Olja Medić
Dr Iva Rosić
Dr Marina Sokić
Ivana Marić
Srđan Dživdžanović

Conference program

3 – 5 June 2026

Day 1 (03.06.)

WP1 - Exploiting Plant-Microbiome molecular crosstalks: diversity, distribution and eco-evolutionary perspectives

WP2 - Crop-Microbiome assembly dynamics under specific environments

08:30 – 09:15 Registration

09:00 – 09:30 Meeting opening and introductory remarks

09:30 – 11:00 WP1 - Part I

(Chairs: Ahmed ABDELFATTAH and Gabriele BERG)

11:00 – 11:40 ☕ Coffee break + Poster session

11:40 – 13:00 WP1 - Part II

13:00 – 14:00 🍽️ Lunch

14:00 – 15:30 WP2 - Part I

(Chairs: Elodie VANDELLE and Gordana RACIC)

15:30 – 16:10 ☕ Coffee break + Poster session

16:10 – 18:30 WP2 - Part II

20:00 🌿 Welcome Mixer at Botanical Garden „Jevremovac“

Day 2 (04.06.)

WP3 - Crop microbiomes and plant diseases: from dysbiosis to increased defenses

WP4 - From current microbial inoculants to synthetic communities

09:00 – 10:30 WP3 - Part I

(Chairs: Joël POTHIER and Renata ARTIMOVÁ)

10:30 – 11:10 ☕ Coffee break + Poster session

11:10 – 13:00 WP3 - Part II

13:00 – 14:00 🍽️ Lunch

14:00 – 15:00 WP4 - Session Part I

(Chairs: Anna BONATERRA and Claire PRIGENT-COMBARET)

15:00 – 15:40 ☕ Coffee break + Poster session

15:40 – 17:40 WP4 - Session Part II

18:00 🚢 Excursion: Cruise on the Sava and Danube rivers

Day 3 (05.06.)

WP5 & strategic meetings

09:00 – 10:30 Working Group meetings

(WG1, WG2, WG3)

10:30 – 11:00 ☕ Coffee break

11:00 – 12:30 Working Group meetings

(WG4, WG5)

12:30 – 13:00 ☕ Coffee break

13:00 – 13:30 Grant Awarding scheme overview session

(Chair: Ivan NIKOLIĆ)

13:30 – 14:00 Glossary/Terminology session

(Chair: Juraj MEDO and Joël POTHIER)

14:00 – 15:00 🍽️ Lunch

15:00 – 17:00 Management Committee meeting

Participation & Deadlines

Important dates

Participation in the 3rd Annual Conference of the MicropBiomes Cost Action requires:

- 1) Pre-registration, as the number of places is limited. All participants wishing to attend must complete the online registration form and submit a **450-word** abstract for either an **oral** or **poster presentation**. Deadline: **12 April 2026**
- 2) Alternatively, corporate participants may upload a **short letter** outlining their interest in the conference.

Detailed abstract preparation guidelines are available at the link below:

https://micropbiomes.eu/wp-content/uploads/2026/03/Abstract_Instructions_Belgrade.pdf

All applications will be subjected to a selection process by the Scientific Committee.

Applicants will be informed of the decision by **27 April 2026**.

Please note that completing the form does NOT guarantee you a place at the conference.

Reimbursement

Participants (in particular early-stage researchers and colleagues from Inclusiveness Target Countries) may be reimbursed for their travel, accommodation, and subsistence costs through the **MicropBiomes COST grant**. Reimbursement requests must be submitted using the online form.

Decisions on reimbursement will be made by the **Scientific Committee**. Travel, accommodation, and subsistence costs will be reimbursed in accordance with the **COST Travel Reimbursement Rules**.

All receipts and invoices must be submitted as soon as possible, and no later than **30 days after the end of the conference**. After this deadline, it will no longer be possible to submit a reimbursement claim.

Costs

As mentioned above, the conference will take place at the **Hotel "Palace"**, Belgrade.

The **participation fee is covered**. The **Local Organizer Support (LOS)** will also cover:

- (a) All coffee breaks
- (b) The **Welcome Cocktail at the Botanical Garden "Jevremovac"**
- (c) Conference materials (including a bag, badge, and PDF abstract book)
- (d) Access to the social event: **cruise on the Danube and Sava rivers**. For more information visit our agency link:

<http://impalaconferences.com/Microbiomes.php>

*** Upon on-site registration, all participants will be required to pay €15 per lunch (€45 in total for lunches on June 3rd–5th). Lunches will be provided on-site during the conference. Please note that payment will be accepted in cash only.**

Accommodation & Transport

Accommodation

Hotel “Palace” might be the most convenient option, as the conference venue is located there. It is also situated in the city center, so most of Belgrade’s main attractions can easily be visited on foot.

If you wish to book a room at Hotel Palace, please follow the link provided by our agency: <http://impalaconferences.com/Microbiomes.php>. Options include single and double rooms. You can see the room types and details on the hotel website linked above.

Check-in starts at 2:00 p.m, while check-out is until 12:00 p.m.

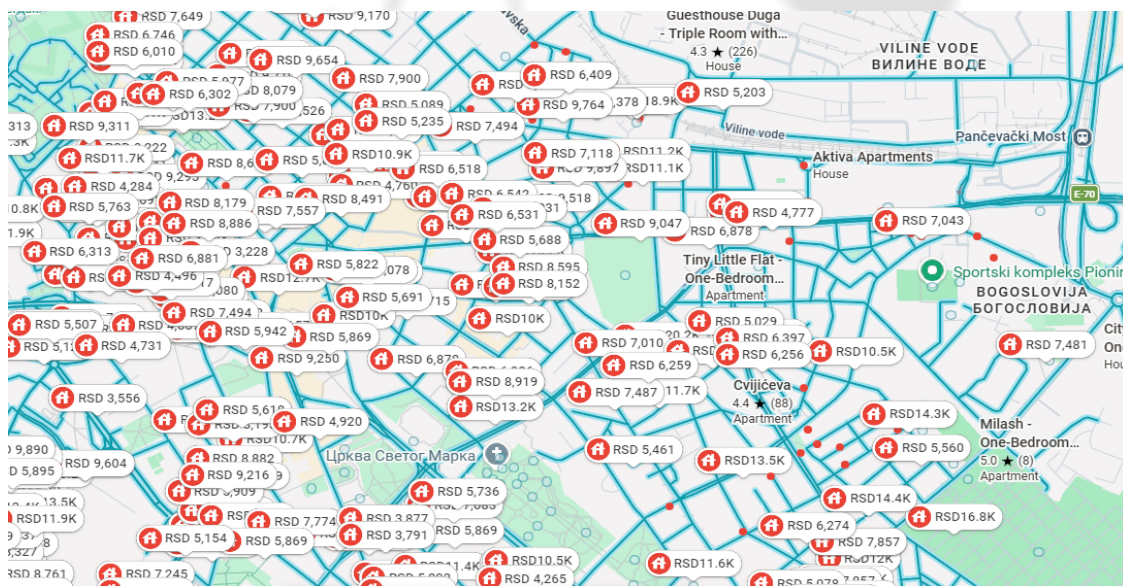

Belgrade offers many hotels and apartments (as you can already see from the picture above), so if you would prefer another type of accommodation, feel free to contact the local organizing committee and we will gladly help you with recommendations or reservations:

Iva Rosić (riva@ipb.ac.rs); Marina Sokić (amarina@ipb.ac.rs); Ivana Marić (mivana@ipb.ac.rs)



Accommodation & Transport

How to reach the conference venue

The conference begins on the morning of 3 June, so participants are advised to arrive in Belgrade the day before. The meeting will conclude on 5 June in the afternoon (for Management Committee members).

Belgrade has one airport - Belgrade Nikola Tesla Airport. The trip from the airport to Hotel Palace (and city center) usually takes 30-60 minutes, depending on traffic and the mode of transportation.

Public transportation in Belgrade is currently free, so the cheapest option is to take a bus. There are several routes connecting the airport with the city center, depending on the time of your arrival. All available options are listed and described here: <https://beg.aero/eng/practical-informations/public-transportation>

For a more comfortable option, you can take a taxi. One reliable service is Pink Taxi, which can even be booked via Viber before arrival:

<https://pinktaxi.info/en/belgrade-airport-taxi/>

A taxi ride to the city center usually takes 20–30 minutes.

Another convenient option is to book a transfer directly from the airport to your chosen accommodation through our agency. For more information, please follow:

<http://impalaconferences.com/Microbiomes.php>

There are also many car rental and car-sharing options available at the airport - ideal for brave and patient drivers ready to experience the adventure known as Belgrade traffic.



What to do in Belgrade?



Explore Kalemegdan Park and the Belgrade Fortress, meet the famous Pobednik, and enjoy one of the most beautiful views in the city where the Sava and Danube rivers meet.

<https://www.beogradskatvrđjava.co.rs/%d0%b8%d0%bd%d1%84%d0%be/?lang=en>



Visit Prince Mihailo Monument in Republic Square - the famous Belgrade meeting point locals call “kod konja” (“by the horse”) - just in front of the National Museum of Serbia, which houses rich collections of European and Serbian art, including works by Vincent van Gogh, Claude Monet, and Pablo Picasso.

<http://www.narodnimuzej.rs/?lang=en>

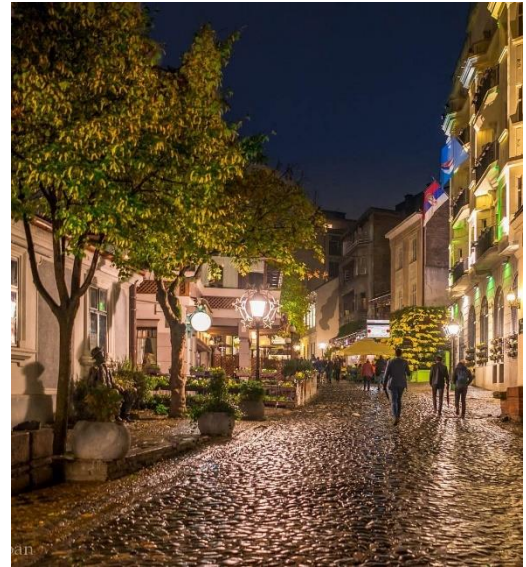

Stroll through Skadarlija, Belgrade's historic bohemian quarter, famous for its cobble streets, traditional restaurants (kafana), live music, and the lively atmosphere that has inspired artists, writers, and musicians for more than a century. You can also join a dinner with live music organized by our agency - reserve your spot via the link: <http://impalaconferences.com/Microbiomes.php>



Discover Belgrade's scientific heritage at the Serbian Academy of Sciences and Arts (Palace of Science) and the interactive Museum of Science and Technology, where exhibitions showcase Serbia's contributions to science, technology, and innovation.

<https://muzejnt.rs/eng/>; <https://palatanauke.rs/en/>



Visit the Nikola Tesla Museum, dedicated to the life and inventions of the famous scientist Nikola Tesla, where original documents, personal belongings, and demonstrations of his groundbreaking electrical experiments are on display.

<https://tesla-museum.org/en/home/>



Visit the Museum of Yugoslavia and the nearby House of Flowers, the mausoleum of Josip Broz Tito, where exhibitions present the history, culture, and legacy of the former Yugoslavia.

<https://muzej-jugoslavije.org/en/>

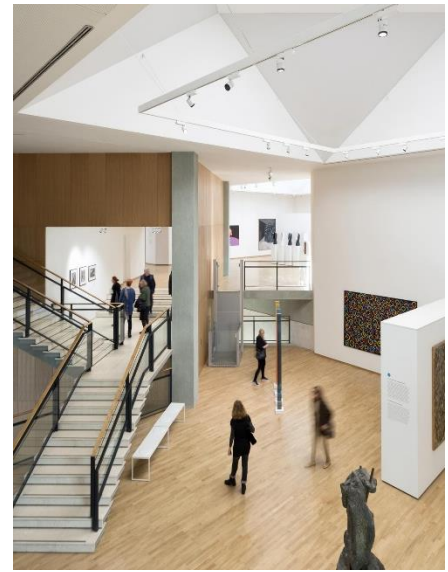

Visit the Museum of Contemporary Art Belgrade, located where the Sava and Danube rivers meet, with exhibitions presenting modern and contemporary art from Serbia and the international art scene.

<https://msub.org.rs/?lang=en>

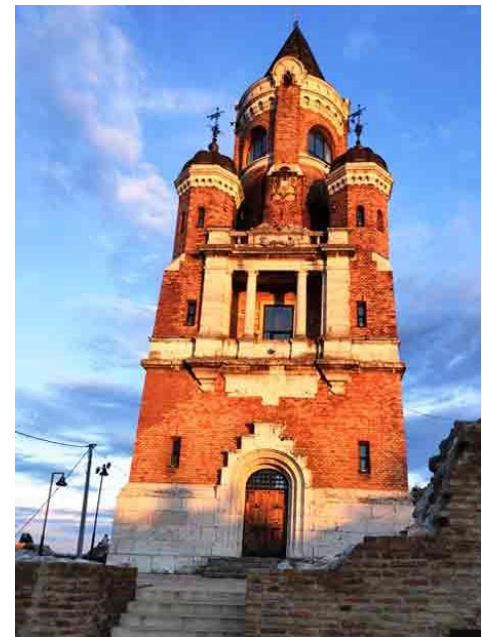

Explore Zemun, a historic riverside district with a distinct atmosphere, and climb the Millennium Tower on Gardoš Hill for one of the most beautiful views over the Danube and the city.

Useful information

Getting Around Belgrade

City center can easily be explored on foot and public transport is free!

Emergency contacts

- 1) Police: 192
- 2) Fire Department: 193
- 3) Ambulance: 194

Weather in June

June in Belgrade is usually warm and pleasant, with daytime temperatures typically ranging from 24–30 °C. Evenings are comfortable (around 15–20 °C), making it a great time to explore the city. Just keep a light jacket for the evenings and the occasional summer shower.

Currency

The official currency in Serbia is the Serbian dinar (RSD). For orientation, €1 is approximately 117,4 RSD, although exchange rates may vary slightly. Cash and card payments are widely accepted in Belgrade, and ATMs are easy to find throughout the city. Exchange offices (menjačnica) are common and usually offer good rates for major currencies such as euros and US dollars.

For small purchases, cafés, taxis, or markets, it is still useful to have some cash in dinars.



See you
soon!

